



INSTRUCTION BULLETIN

No. 9012973
Machine: T17
Published: 12-2015
Rev. 00

NOTE: DO NOT DISCARD the Parts List from the Instruction Bulletin. Place the Parts List in the appropriate place in the machine manual for future reference. Retaining the Parts List will make it easier to reorder individual parts and will save the cost of ordering an entire kit.

NOTE: Numbers in parenthesis () are reference numbers for parts listed in Bill of Materials.

Installation instructions for **kit number 9020105**

SYNOPSIS:

This kit contains the parts needed to install the headlight kit on T17 scrubbers.
Please follow step-by-step instructions.

SPECIAL TOOLS / CONSIDERATIONS: NONE

(Estimated time to complete: 1.5 hours)

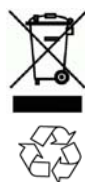

PROTECT THE ENVIRONMENT

Please dispose of packaging materials, used machine components such as batteries and fluids in an environmentally safe way according to local waste disposal regulations.

Always remember to recycle.

PREPARATION:

1. Park the machine on a clean level surface, turn off the machine, set the parking brake, and remove the key.

FOR SAFETY: Before leaving or servicing machine, stop on level surface, turn off machine, and remove key.

2. Disconnect the battery cable from the machine.



WARNING: Always disconnect battery cables from machine before working on electrical components.

INSTALLATION:

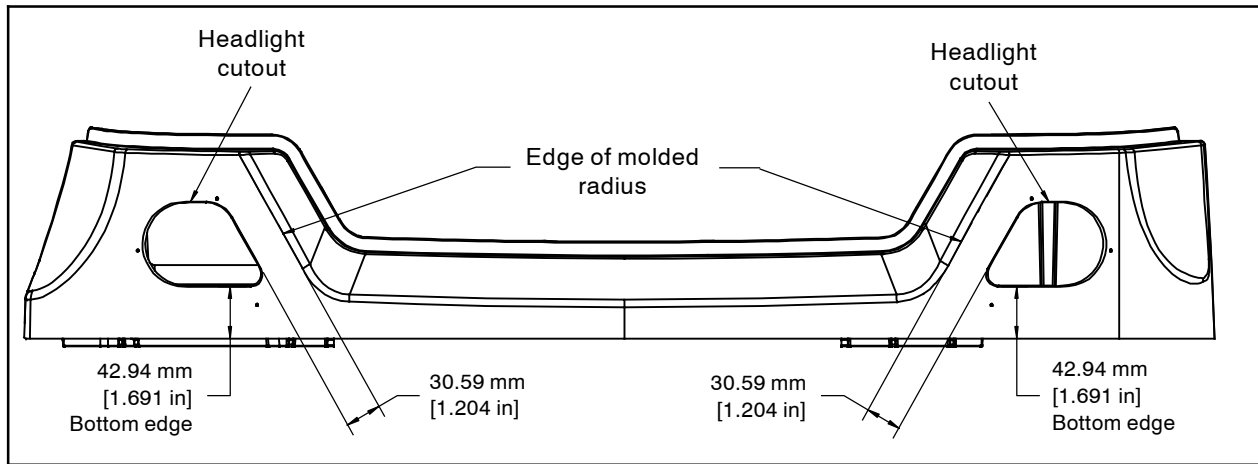

FIG. 1

1. Tape both headlight bezel templates (9) onto the front platform. (Fig. 1 / Fig. 2)



FIG. 2

2. Cut the holes for both headlights into the front platform. (Fig. 1 / Fig. 2 / Fig. 3)



FIG. 3

3. Remove the headlight bezel templates (9) from the front platform and discard both templates.
4. Clean both newly cut holes as necessary so the left headlight bezel (1) and right headlight bezel (2) fit easily into the holes. (Fig. 3)

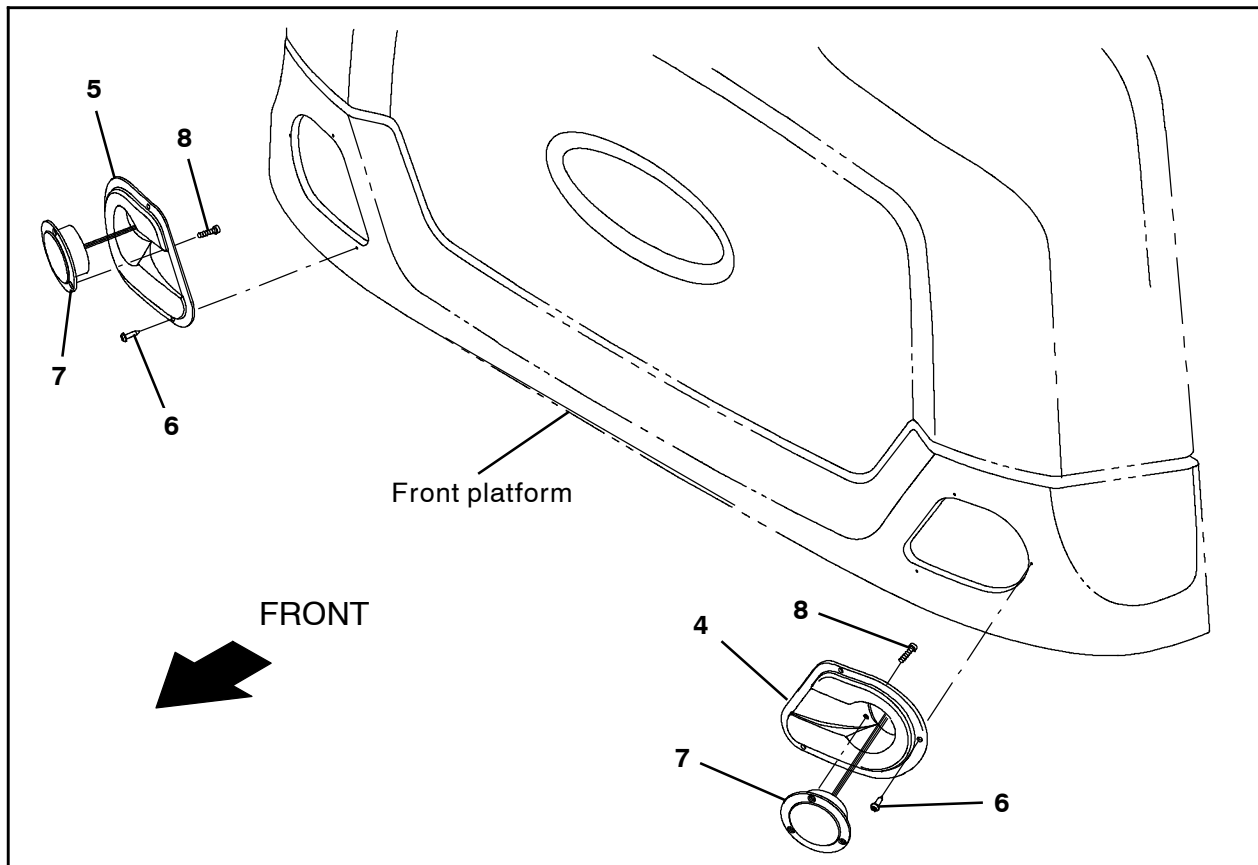

FIG. 4

5. Use three M3 pan screws (8) to install a light assembly into the right headlight bezel (5) and the left headlight bezel (4). (Fig. 4)
6. Use the right headlight assembly as a template and drill a 0.078" (1.98 mm) hole through each of the three holes in the bezel and through the front platform. (Fig. 4 / Fig. 5)
8. Connect the main wire harness to both light assemblies (3). (Fig. 4 / Fig. 9 / Fig. 10)
9. Use three pan screws (6) to install the right headlight assembly and the left headlight assembly onto the front platform. (Fig. 4 / Fig. 6)



FIG. 5

7. Use the left headlight assembly as a template and drill a 0.078" (1.98 mm) hole through each of the three holes in the bezel and through the front platform. (Fig. 4 / Fig. 5)



FIG. 6

10. Remove the access panel from the machine. Set the access panel and hardware side. (Fig. 7)

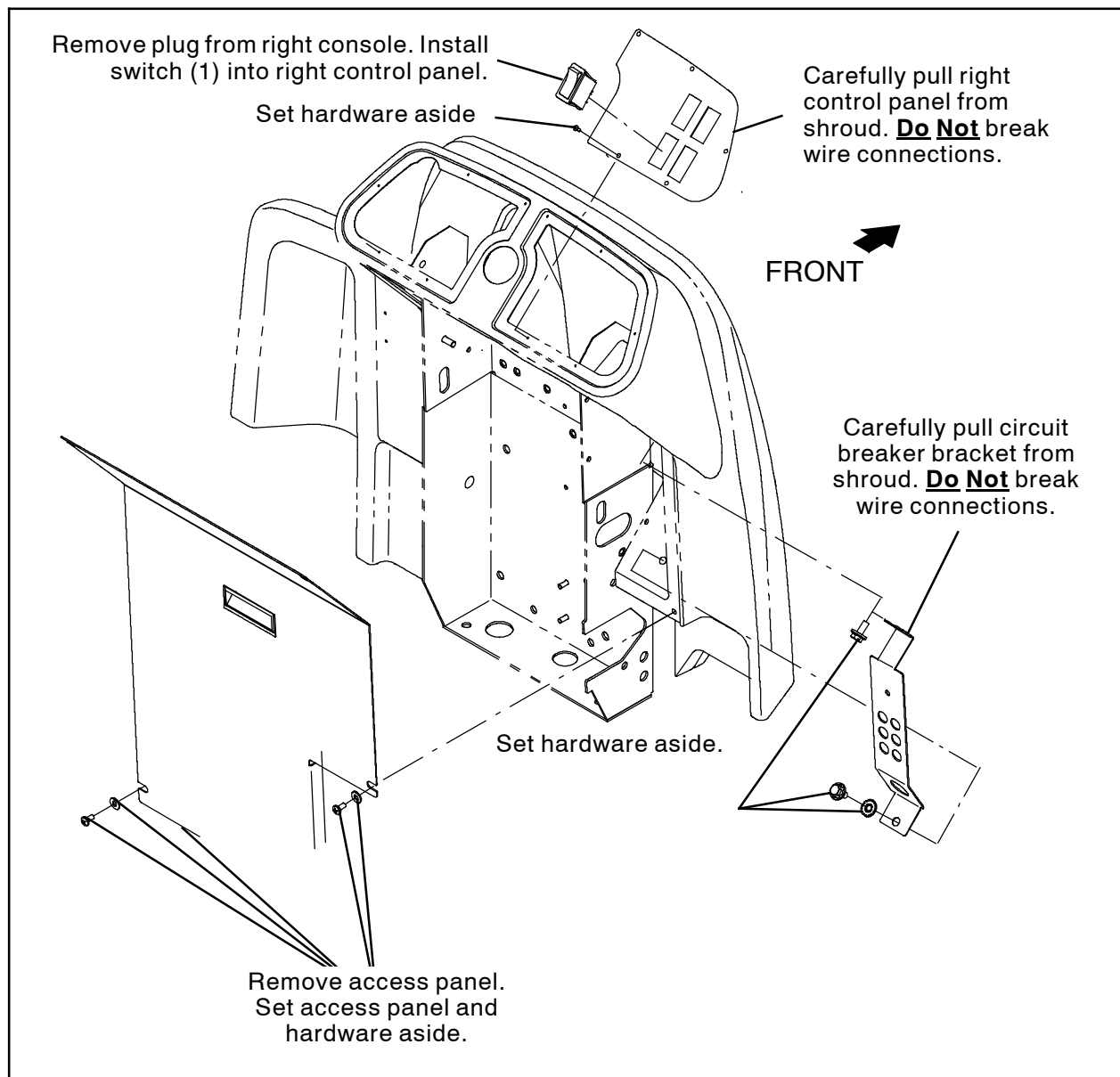

FIG. 7

NOTE: The rocker switch (1) does not need to be installed into the control panel if the machine is equipped with a warning light. A rocker switch will already be installed. Proceed to Step 17.

11. Remove the hardware securing the control panel to the front shroud. Set the hardware aside. (Fig. 7)
12. Carefully remove the control panel from the front shroud. **Do Not** break wire / cable connections. (Fig. 7)
13. Remove the plug from the control panel. Discard the plug. (Fig. 7)
14. Insert the rocker switch (1) into the location in the control panel where the plug was previously located. (Fig. 7)
15. Connect the main wire harness to the rocker switch (1). (Fig. 7 / Fig. 9 / Fig. 10)
16. Reinstall the control panel onto the machine. (Fig. 10)
17. Remove the M8 hex screws securing the circuit breaker bracket to the machine. Set the M8 hex screws aside. (Fig. 7)
18. Carefully pull circuit breaker bracket out far enough to access the main wire harness connectors located behind the bracket. **Do Not** break any wire connections. (Fig. 7)

19. Insert the 2.5- Amp circuit breaker (3) into circuit breaker location 12 in the circuit breaker bracket. (Fig. 8)

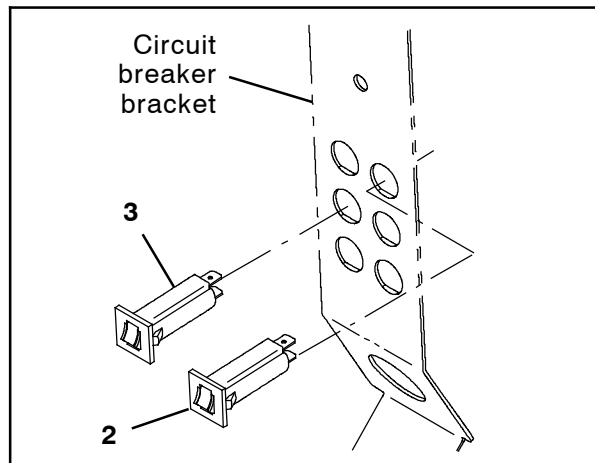

FIG. 8

NOTE: The 15- Amp circuit breaker does not need to be installed if the machine is equipped with a warning light. A 15- Amp circuit breaker will already be installed. Proceed to Step 21.

20. Insert the 15- Amp circuit breaker (2) into circuit breaker location 11 in the circuit breaker bracket. (Fig. 8)

21. Connect the main wire harness to the circuit breakers (2) and (3) installed into the circuit breaker panel in the previous steps. (Fig. 8 / Fig. 9 / Fig. 10)
22. Reinstall the circuit breaker bracket onto the machine. (Fig. 7)
23. Reinstall the access panel onto the machine. (Fig. 7)
24. Reconnect the battery cable to the machine.
25. Start and test the machine. Place the light switch into the ON position. Ensure both headlights function.

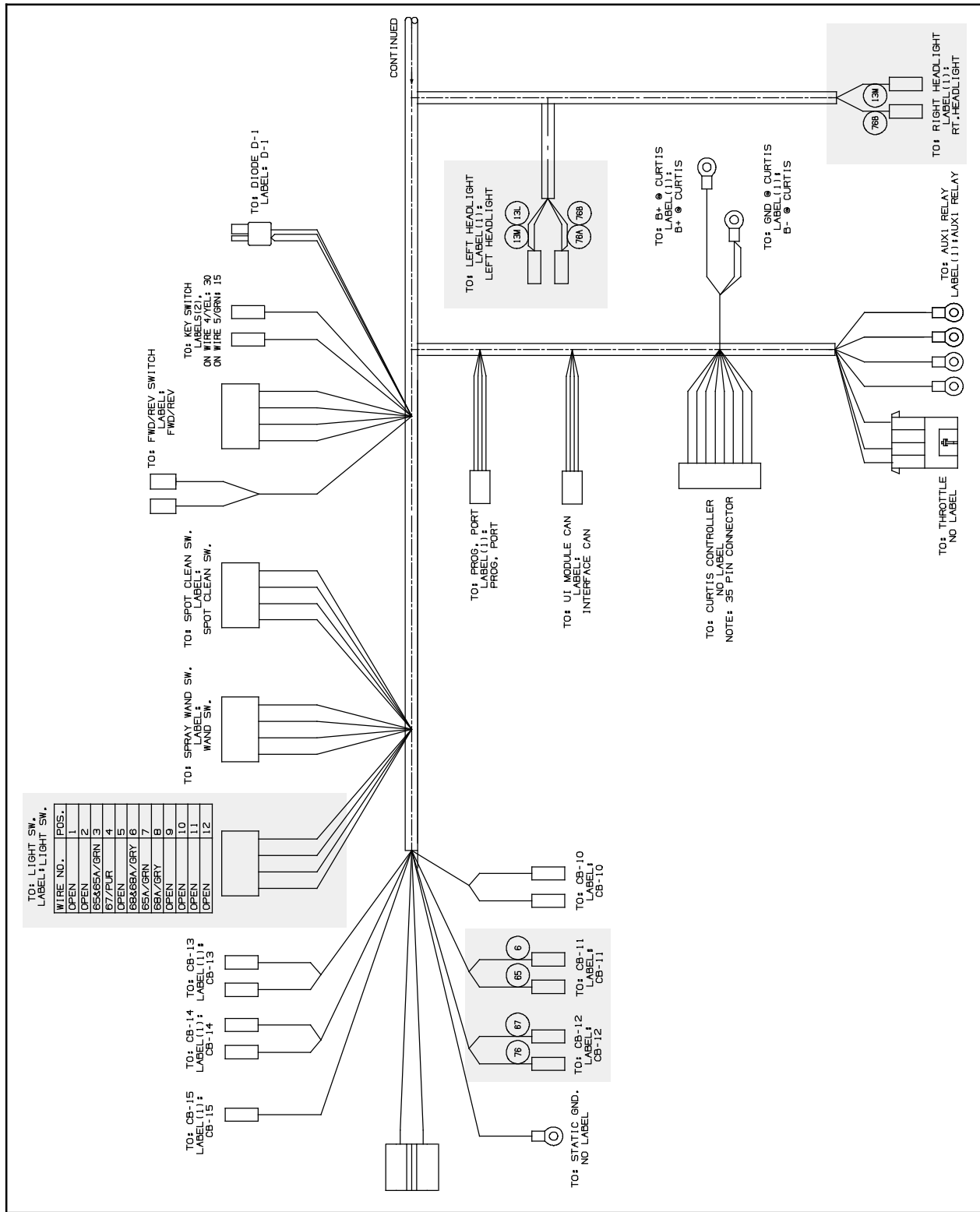

FIG. 9

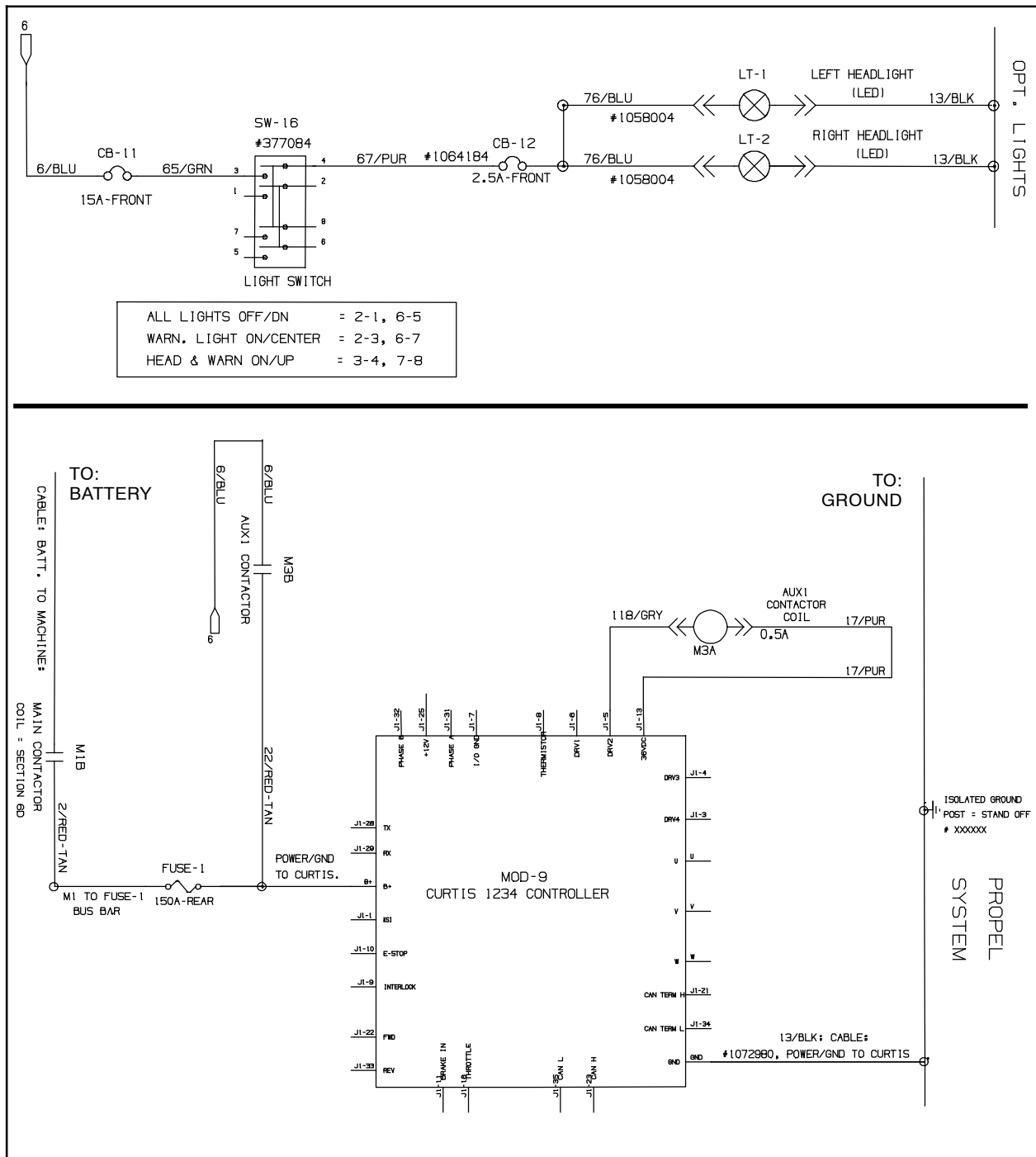

FIG. 10

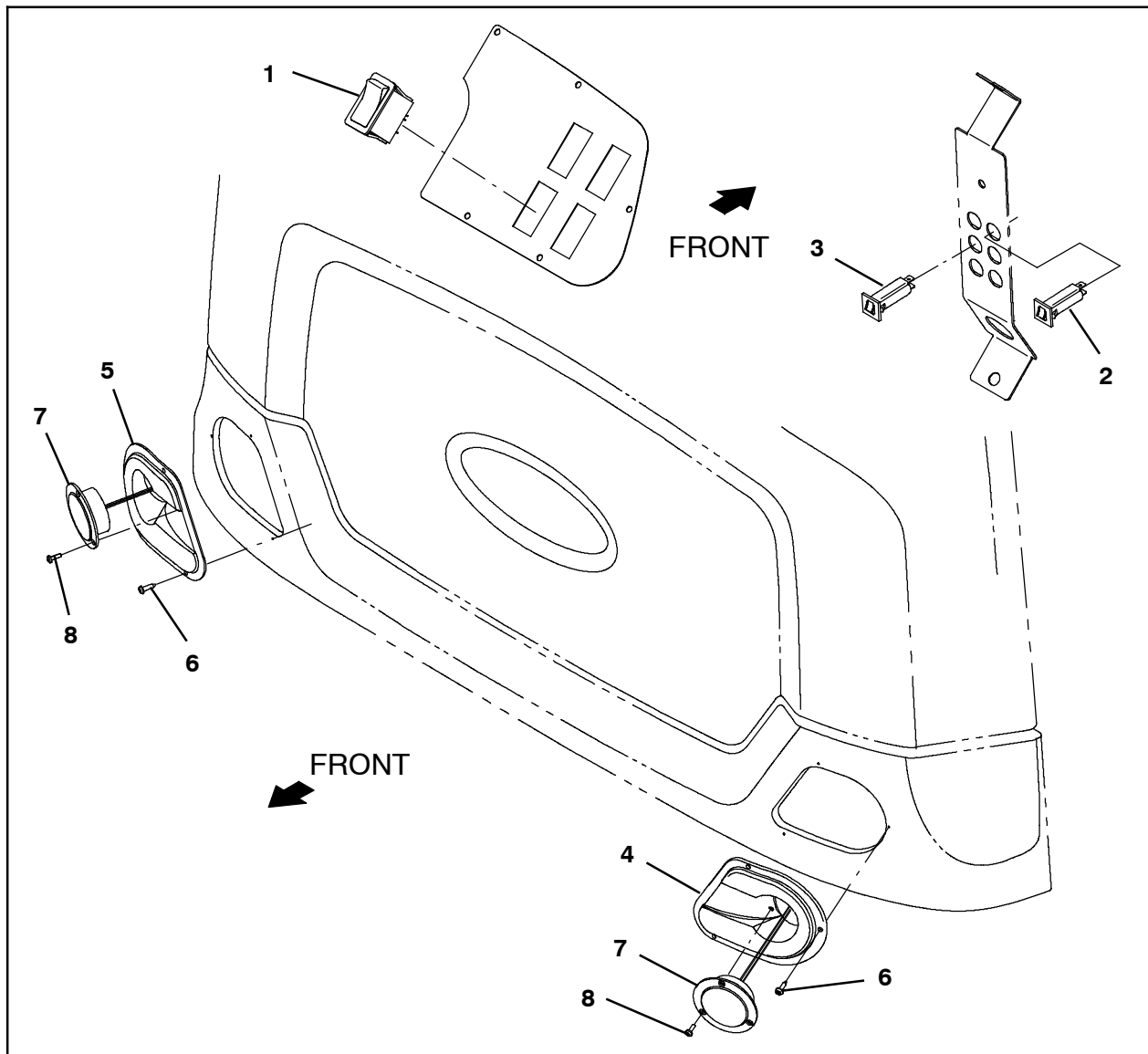

FIG. 11

Bill Of Materials For Light Kit, Front, DI [T17] - 9020105

Ref.	Part No.	Description	Qty.
1	377084	Switch, Rocker, Prgrsv	1
2	1064188	Circuit Breaker, 15.0a, Resettable	1
3	1064184	Circuit Breaker, 02.5a, Resettable	1
4	1202870	Bezel, Headlight, LH [W/Inserts]	1
5	1202892	Bezel, Headlight, RH [W/Inserts]	1
6	140825	Screw, Pan, Phl, 06 X 0.50, Fmg/Ab, Blk	6
7	9008182	Light Assy, Pre- Sweep, Afmkt	2
8	06920	Screw, Pan, Phl, M3 X 0.50 X 10, 4.8	6
9	1208746	Template, Bezel, Headlight [T12]	1

TENNANT COMPANY
P. O. Box 1452
Minneapolis, MN 55440-1452